

Note: Part numbers and standards' values may change. Consult LECO for the latest information.

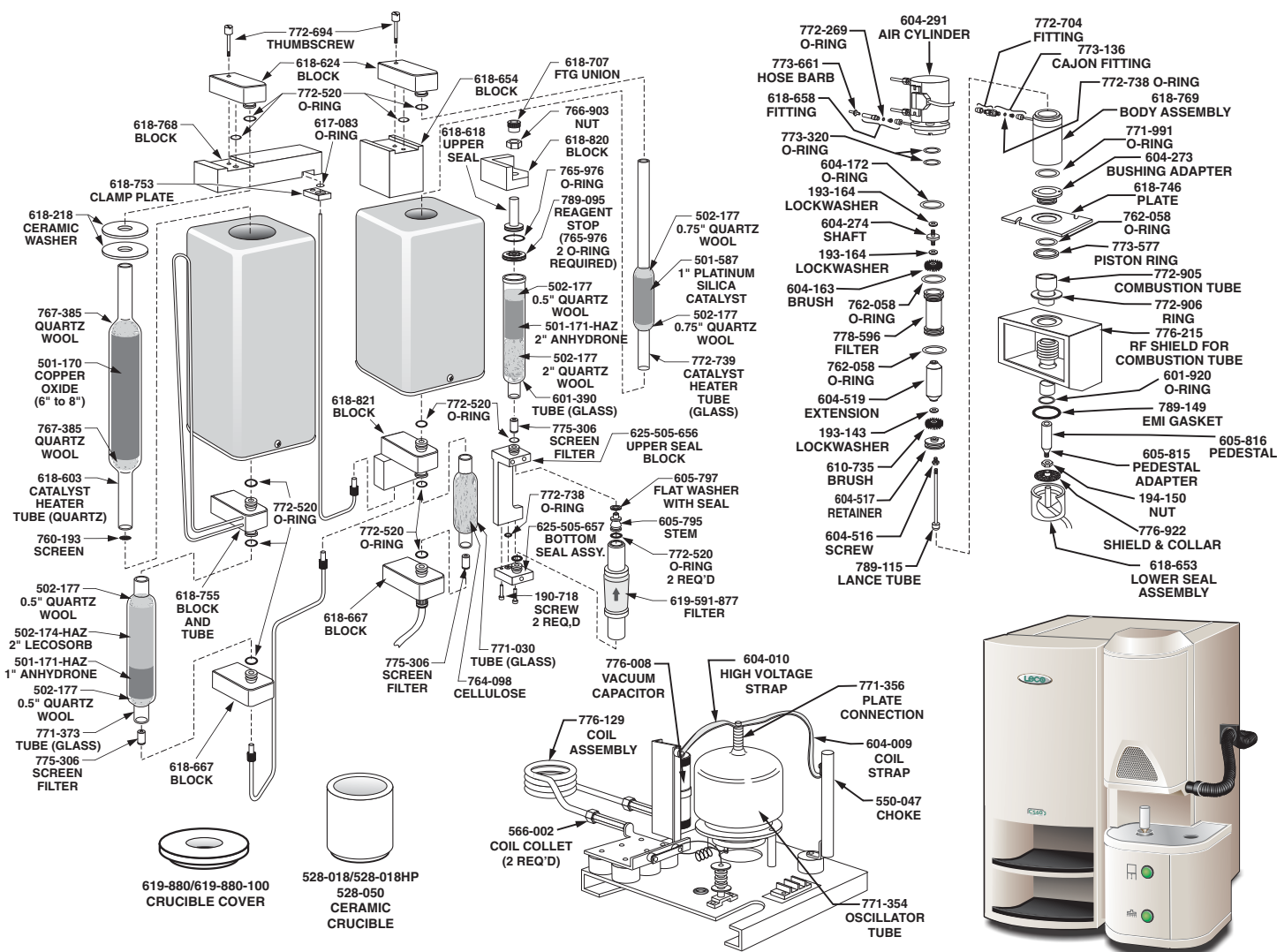

COMBUSTION SUPPLIES

- | | |
|-------------|--|
| 528-018 | Ceramic Crucible 1000/box |
| 528-018HP | 0 Sulfur Blank 1000/box |
| 528-050 | Ceramic Crucible 500/box, bags of 50 |
| 619-880 | Ceramic Crucible Cover with Hole, 1000/box |
| 619-880-100 | Ceramic Crucible Cover with Hole, 100/box |
| 772-905 | Combustion Tube (Quartz) |
| 778-596 | Filter Screen (SST Filter) |
| 772-381 | Lance Cleaning Wire |
| 789-115 | Lance Tube (Quartz) |
| 610-735 | Lower Cleaning Brush (Reworked Brush) |
| 762-058 | O-ring |
| 605-816 | Silicon Nitride Pedestal |
| 772-906 | Teflon Support Ring (Combustion Tube Ring) |
| 782-880 | Vacuum Cleaner Filter |
| 501-082 | Wire Cleaning Brush |

ACCELERATORS

- | | |
|---------|--|
| 502-492 | Copper Accelerator HP (0.44 lb./200 g) |
| 501-263 | Copper Metal Accelerator 1.36 kg (3 lb.) bottle |
| 501-640 | Copper Metal Accelerator 9 kg (20 lb.) container |
| 501-264 | Copper Metal Accelerator, 227 g (0.5 lb.) bottle |

ACCELERATORS (cont'd)

- | | |
|---------|---|
| 502-231 | High Purity Iron Accelerator 454 g (1 lb.) bottle |
| 501-077 | Iron Chip Accelerator 0.9 kg (2 lb.) bottle |
| 763-026 | LECOCEL [®] 13.6 kg (30 lb.) container |
| 763-266 | LECOCEL [®] 2.27 kg (5 lb.) bottle |
| 502-297 | LECOCEL [®] II (30 lb./13.6 kg) |
| 501-008 | LECOCEL [®] II 2.27 kg (5 lb.) bottle |
| 502-173 | LECOCEL [®] II HP 750 g (1.7 lb.) bottle |
| 763-263 | LECOCEL [®] III 2.27 kg (5 lb.) bottle |
| 763-027 | LECOCEL [®] III 13.6 kg (30 lb.) container |

CATALYSTS AND REAGENTS

- | | |
|-------------|-------------------------------------|
| 501-171-HAZ | Anhydrone 454 g (1 lb.) bottle |
| 764-098 | Cellulose 454 g (1 lb.) package |
| 502-174-HAZ | Lecosorb 500 g bottle, 20-30 mesh |
| 502-176-HAZ | Lecosorb 500 g bottle, 8-20 mesh |
| 501-587 | Platinum/Silica 15 g bottle |
| 502-177 | Quartz Wool 50 g package |
| 501-170 | Rare Earth Copper Oxide 50 g bottle |

Please Note: Quartz Tubes are typically utilized for higher temperature applications (i.e. catalyst tubes). Glass reagent/filter tubes are designed for lower temperature applications. Glass tubes should not be used in place of quartz tubes.

See reverse side for contact information

REAGENT TUBES

- 771-030 Glass Tube, requires two (2) 772-520 O-rings for sealing
- 771-373 Glass Tube, requires two (2) 772-520 O-rings for sealing
- 618-603 Quartz Catalyst Tube, requires two (2) 772-520 O-rings for sealing, and a 772-738 O-ring for the removable block
- 772-739 Glass Catalyst Tube, requires two (2) 772-520 O-rings for sealing, and a 772-738 O-ring seals the removable block

OPERATION ACCESSORIES

- 619-591-877 Balston Filter
- 761-929 Crucible Tongs
- 789-149 EMI Gasket
- 775-307 Filter Removal Tool (Thumbscrew)
- 775-306 Secondary Filter, 10 micron
- 503-032 Glass Accelerator Scoop
- 773-579 Metal Accelerator Scoop
- 764-078 One gram Weight
- 760-138 Sample Tweezers
- 619-825 Trap Tube for CSLS600 (only)
- 501-241 Vacuum Grease

*NOTE: Part numbers and standards' values may change.
Consult LECO for latest information.*

United States:
Ph: 1-800-292-6141
Fax: 269-982-8977
Canada:
Ph: 1-800-268-0215
Fax: 905-564-6582

represented by:

Other Countries:
Ph: 269-983-5531
Fax: 269-983-3850

© 2011 LECO Corporation