

Note: Part numbers and standards' values may change. Consult LECO for the latest information.

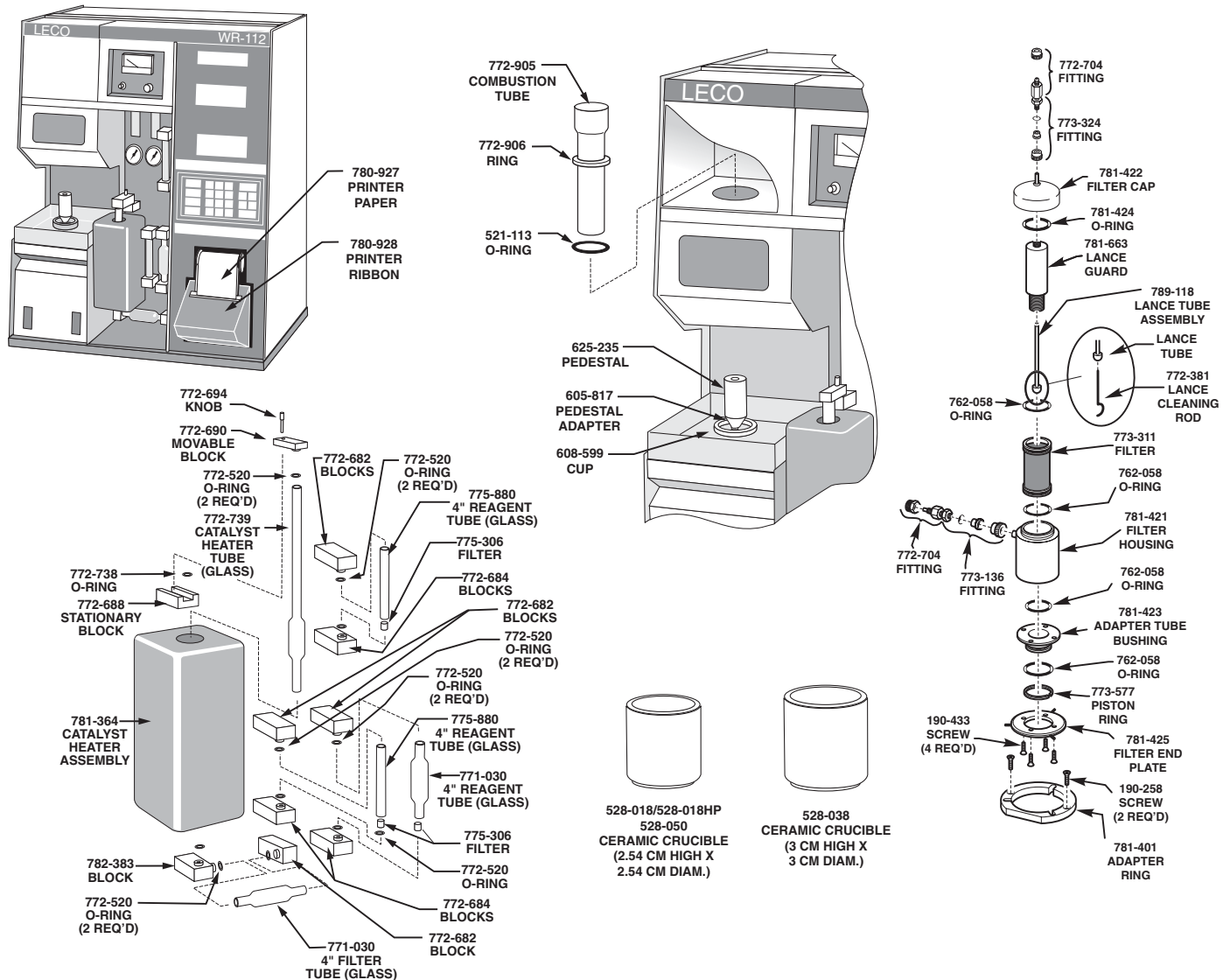

**COMBUSTION SUPPLIES**

- 528-018 Ceramic Crucible 1000/box
- 528-050 Ceramic Crucible 500/box, bags of 50
- 528-038 Ceramic Crucible 1000/box
- 772-905 Combustion Tube (Quartz)
- 501-082 Combustion Tube Cleaning Brush
- 772-381 Lance Cleaning Wire
- 789-118 Lance Tube
- 771-354 Oscillator Tube
- 773-145 Screen Dust Trap Cleaning Brush
- 625-235 Silicon Nitride Pedestal
- 521-113 Silicone O-Ring

**ACCELERATORS**

- 501-263 Copper Metal Accelerator 1.36 kg (3 lb.) bottle
- 501-640 Copper Metal Accelerator 9 kg (20 lb.) container
- 501-077 Iron Chip Accelerator 0.9 kg (2 lb.) bottle
- 763-467 Iron Chip Accelerator 11.35 kg (25 lb.) container
- 501-076 Tin Metal Accelerator 0.9 kg (2 lb.) bottle
- 762-695 Tin Metal Accelerator 11.35 kg (25 lb.) Container

**CATALYSTS AND REAGENTS**

- 501-171-HAZ Anhydron 454 g (1 lb.) bottle
- 501-081 Glass Wool 454 g (1 lb.) box
- 502-174-HAZ Lecosorb 500 g bottle, 20-30 mesh
- 502-176-HAZ Lecosorb 500 g bottle, 8-20 mesh
- 501-060 Manganese Dioxide 60 gram bottle
- 501-587 Platinized Silica (15 g)

**REAGENT TUBES**

- 772-739 Glass Catalyst Tube, requires two (2) 772-738 O-rings for sealing
- 771-030 Glass Tube, requires two (2) 772-520 O-rings for sealing
- 775-880 Glass Tube

Please Note: Quartz Tubes are typically utilized for higher temperature applications (i.e. catalyst tubes). Glass reagent/filter tubes are designed for lower temperature applications. Glass tubes should not be used in place of quartz tubes.

See reverse side for contact information

**OPERATION ACCESSORIES**

768-980	Balston Filter
761-929	Crucible Tongs
503-032	Glass Accelerator Scoop
775-306	Secondary Filter, 10 micron
763-261	Filter Paper 100/package
775-307	Filter Removal Tool (Thumbscrew)
773-579	Metal Accelerator Scoop
760-193	Metal Screen
764-078	One gram Weight
780-927	Printer Paper
780-928	Printer Ribbon
760-138	Sample Tweezers
501-241	Vacuum Grease
789-094	Trap Assembly

**CALIBRATION SAMPLES****STEEL PINS (1 gram pin—454 g/bottle)**

Part No.	% Carbon	% Sulfur
501-674	0.015–0.035	0.005–0.025
501-675	0.050–0.080	0.005–0.025
501-676	0.09–0.15	0.005–0.025
501-677	0.30–0.40	0.005–0.025
501-678	0.50–0.60	0.005–0.025
501-679	0.85–1.00	0.005–0.025
502-449	0.04–0.065	0.280–0.365

**STEEL RINGS (1 gram ring—454 g/bottle)**

Part No.	% Carbon	% Sulfur
501-501	0.0200–0.0400	0.005–0.030
501-502	0.04–0.10	0.005–0.030
501-503	0.10–0.25	0.005–0.030
501-504	0.25–0.50	0.005–0.030
501-505	0.50–0.80	0.005–0.030
501-506	0.80–1.00	0.005–0.030
502-271	0.030–0.080	0.150–0.250
502-364	0.80–1.0	—

**STEEL (150 g/bottle)**

Part No.	Type	% Carbon	% Sulfur
502-808	Silicon	0.019	0.0090

**CALIBRATION SAMPLES (cont'd)****ORE (Drill Tailings) (25 g/bottle)**

Part No.	Type	% Carbon	% Sulfur
502-318		0.25–0.75	0.25–0.75
502-319		1.25–1.75	1.25–1.75
502-320		4.25–5.25	4.25–5.25
502-372		6.75–7.75	3.00–4.00

**TUNGSTEN CARBIDE (100 g/bottle)**

Part No.	% Carbon
501-123	6.00–6.25

**SWEDEN (JERNKONTORETS) (150 g/bottle)**

Part No.	Std. No.	Type	% Carbon	% Sulfur
501-714	24	Low Alloy Steel	0.1744	0.0010
501-718	40	Low Alloy Steel	0.793	0.200

**UNITED KINGDOM (BAS) (100 g/bottle)**

Part No.	Std. No.	Type	% Carbon	% Sulfur
501-801	489-1	White Cast Iron	2.860	0.155

**STEEL PIN (1 g pin—100 g bottle)**

Part No.	ppm Carbon	ppm Sulfur
502-412	50–100	50–100

**STAINLESS STEEL PELLET (1 g pellet—100 g bottle)**

Part No.	% Carbon	% Sulfur
502-414	0.005–0.030%	0.001–0.030%

**WHITE IRON (250 g bottle)**

Part No.	% Carbon	% Sulfur
501-024	3.1–3.5	0.02–0.08

NOTE: Part numbers and standards' values may change. Consult LECO for latest information.

**United States:**

Ph: 1-800-292-6141  
Fax: 269-982-8977

**Canada:**

Ph: 1-800-268-0215  
Fax: 905-564-6582

represented by:

**Other Countries:**

Ph: 269-983-5531  
Fax: 269-983-3850

© 2010 LECO Corporation